

MTi Filters

by PROCOPI

Sand filters



MTi 500 filter



MTi 400 EH filter



MTi 400 filter

FEATURES

Simple, swift assembly,

The 6-way valve is incorporated directly into the filter lid,

The laterals are replaced by a "Collector plate" for highly efficient filtration,

Modular design, facilitates storage,

Compatible with Aqua Plus pumps,

The waste water connection is transparent to monitor water turbidity during backwash,

Parameter set, direct reading pressure gauge.



MGi 500 group

MTi Filters

by PROCOPI

MTi filters are the perfect filtration solution for smaller pools whether above-ground or in-ground.

VALVE

The 6-way valve is incorporated directly into the filter lid. This design avoids any risk of leaks and saves precious time during installation.

FILTRATION



MATERIAL

The MTi filter is made of ABS treated to withstand the effects of exposure to ultra-violet (UV) radiation.

STORAGE

The lid of the filter can be turned upside down and fitted into the filter body, this significantly reduces the volume of the filter and thus facilitates storage and transport.

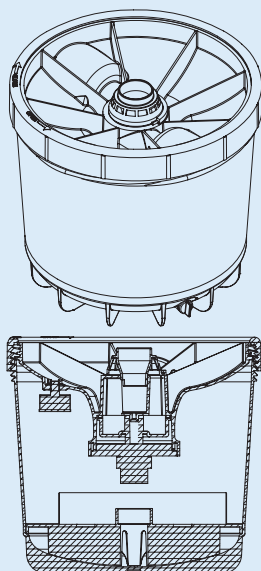

For example: 1,188 MTi 400 filters can be loaded into a standard sized truck, that is twice as many "standard filters" as usual.

	DIAMETER (mm)	HEIGHT (mm)	FLOW RATE (m³/h)	FILTER MEDIUM (Kg of sand)
MTi 400	400	540	6	20
MTi 400 EH	400	640	6	25
MTi 500	500	780	10	50

The MTi filters can be dismantled to provide access to the interior of the filter body. Loading and changing of the filter medium, calibrated sand: 0.6 / 1.25 mm, is made very straightforward.

The more standard laterals are replaced by a "collector plate" that provides the same filtering finesse as filters used in commercial installations that comply with that German DIN standards.

CONNECTIONS

The MTi filter is delivered with either:
barbed inlets/outlets, 38 mm
barbed inlets/outlets, 45 mm
slip socket inlets/outlets, 50 mm

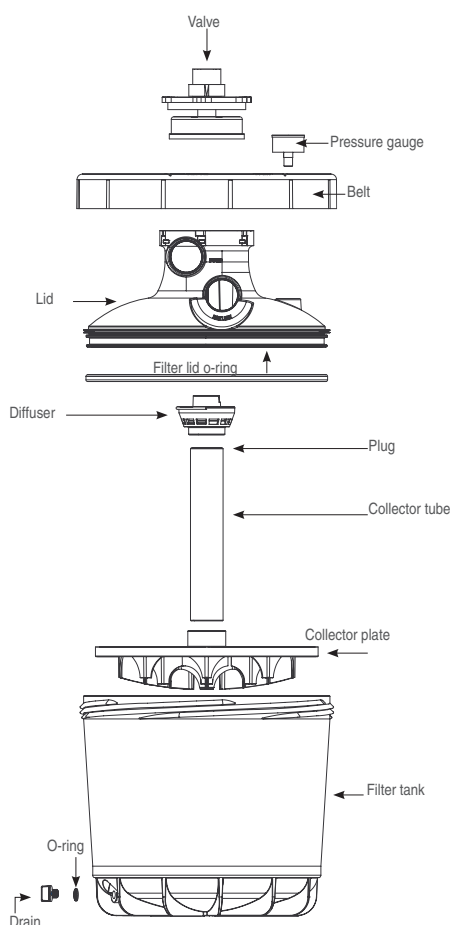

TURBIDITY UNION

The waste water connection on all models is transparent to allow monitoring of water turbidity during backwash operations.



MTi 500 filter

TECHNICAL DATA

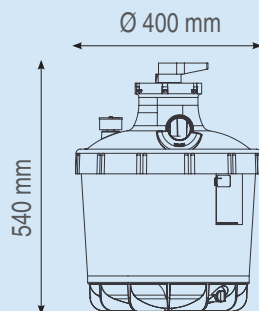

MTi 400

Flow rate: 6 m³/h

Weight: 20 Kg of sand

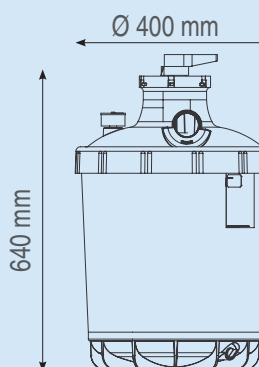

MTi 400 EH

Flow rate: 6 m³/h

Weight: 25 Kg of sand

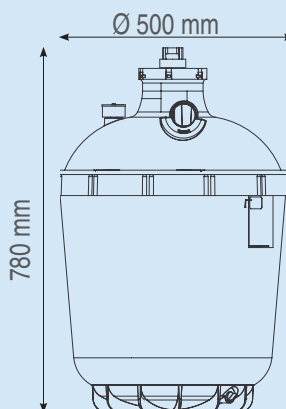

MTi 500

Flow rate: 10 m³/h

Weight: 50 Kg of sand

PRODUCTION

Every component of the MTi filter is produced by thermoplastic injection (anti-UV treated ABS) on fully automated 750 and 1,500 metric ton presses.

The MTi manufacturing plant boasts a large yet reactive production capacity that can be swiftly adjusted to meet market demands.

COLOURS

The filter body and lid can be made in the colour of your choice (as of 500 items).

UNIVERSAL BASE

The MTi universal base comprises:

- the filter base
- the pump base, in the filtration group configuration, the pump base is clipped onto the filter base using the tabs provided for this purpose.



MTi filters are also available incorporated into a filtration group.



MGi 400 group



MGi 500 group

DESIGNATION		FLOWRATE *** at 8 mWC (m³/h)	POWER		POWER SUPPLY (V) - 50Hz	CURRENT (A)	WEIGHT (Kg)
			P1 (kW)*	P2 (kW)**			
MGi 400 group	Aqua Plus 4 pump	4	0.35	0.18	230	1.95	6.30
	Aqua Plus 6 pump	6	0.45	0.25	230	2.30	6.60
MGi 400 EH group	Aqua Plus 6 pump	6	0.45	0.25	230	2.30	6.60
MGi 500 group	Aqua Plus 8 pump	8	0.60	0.40	230	2.70	7.50
	Aqua Plus 11 pump	10	0.69	0.45	230	3.20	7.60

* P1 indicates the total power consumed by the pump.

** P2 indicates the power available at the motor shaft.

*** Flow rate quoted for a through rate of 50m³/h/m² of filter surface area

DIMENSIONS

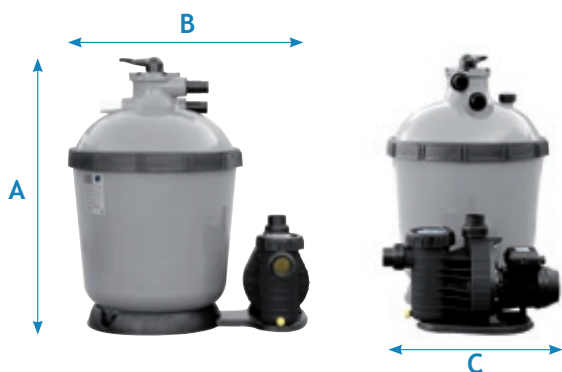

	MGi 400 group	MGi 400 EH group	MGi 500 group
A	540	640	795
B	660	660	715
C	496	496	511
Ø	400	400	500



Dealer's stamp:

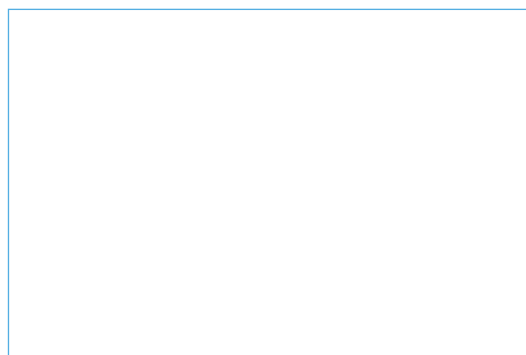

Non-contractual document. Data is provided for information purposes only and may be subject to modification without prior notification. Copyright protected. Do not filter. Created by: Groupe PROCOPI (10/2006)